

SL-W Series

● Port size: R1/4 to R1/2

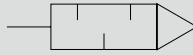

JIS symbol



Specifications

1 MPa ≈ 145.0 psi, 1 MPa = 10 bar

Item	SL-8A-W	SL-10A-W	SL-15A-W
Working fluid	Compressed air		
Max. working pressure MPa	0.9 (≈130 psi, 9 bar)		
Min. working pressure MPa	0 (≈0 psi, 0 bar)		
Proof pressure MPa	1.35 (≈195 psi, 13 bar)		
Fluid temperature °C	5 (41°F) to 60 (140°F)		
Ambient temperature °C	-10 (14°F) to 60 (140°F) (no freezing)		
Port size	R 1/4	R 3/8	R 1/2
Weight	g 75	g 100	g 105
Applicable cylinder tube size	ø50 to ø100	ø63 to ø140	ø75 to ø180
Noise reduction effect dB [A]	20 or more		
Flow rate *1 m ³ /min (ANR)	2.4	3.2	4.1
Effective cross-sectional area mm ²	36	48	61

*1: Flow rate is the atmospheric pressure conversion value at pressure 0.5 MPa.

How to order

SL - **8A** - W

● Replacement element

SL - **8A** - EL

A Port size	
8A	R1/4
10A	R3/8
15A	R1/2

Dimensions/Internal structure and main parts list

● SL-8A to 15A-W

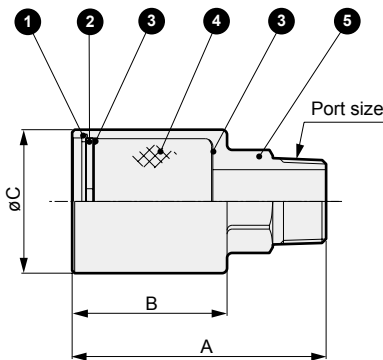

Model No.	Port size	A	B	øC	D
SL-8A-W	R1/4	64	41	30	17
SL-10A-W	R3/8	74.5	49.5	36	24
SL-15A-W	R1/2	77.5	49.5	36	24

No.	Part name	Material
1	C snap ring	Stainless steel
2	Perforated metal	Stainless steel
3	Wire mesh	Stainless steel
4	Element	Vinylidene chloride
5	Body	Aluminum

⚠ Safety precautions

■ Design/selection

⚠ WARNING

- This product is for industrial use. Do not use for medical purposes, or in any equipment or circuit that concerns human life.

■ Working environment

- This product has outdoor specifications, but should not be used in the following environments.
 - When the ambient temperature and product temperature exceed the range of -10 to 60°C. (The product temperature is at risk of exceeding the ambient temperature when exposed to direct sunlight.)
 - Where air freezes.
 - In atmospheres containing corrosive gases, liquids and chemicals.
 - Locations with vibration or impact.

■ Use/maintenance

⚠ WARNING

- Do not install the exhaust outlet of the silencer facing upward. Also, implement measures to prevent foreign matter, dust, and rainwater from entering the exhaust outlet.

⚠ CAUTION

- Use appropriate torque to tighten the pipes when connecting them.
- Noise reduction effect values are based on JIS standards.

[Recommended tightening torque]

Port thread	Tightening torque N·m
R1/4	6 to 8
R3/8	13 to 15
R1/2	16 to 18

- Silencing could vary with the type of circuit and pressure used.
- Use only compressed air. Air containing corrosive gases, fluids, or chemicals could result in body damage or rubber deterioration.
- This product is guaranteed for outdoor use, but not corrosion resistance (no rust or discoloration).

⚠ CAUTION

- Do not apply a load to the product outside the parameters of use. (Do not climb/step onto the product.)
- Check that the C snap ring of the silencer does not pop off when removed or attached.
- Assemble the C snap ring of the silencer accurately when replacing the element. Parts used inside could pop out and cause problems if assembly is not complete.
- Depending on the working conditions, the element could clog and reduce exhaust in the silencer. Service, clean, and replace the element of the product regularly.